

# KOBE Style Bladder

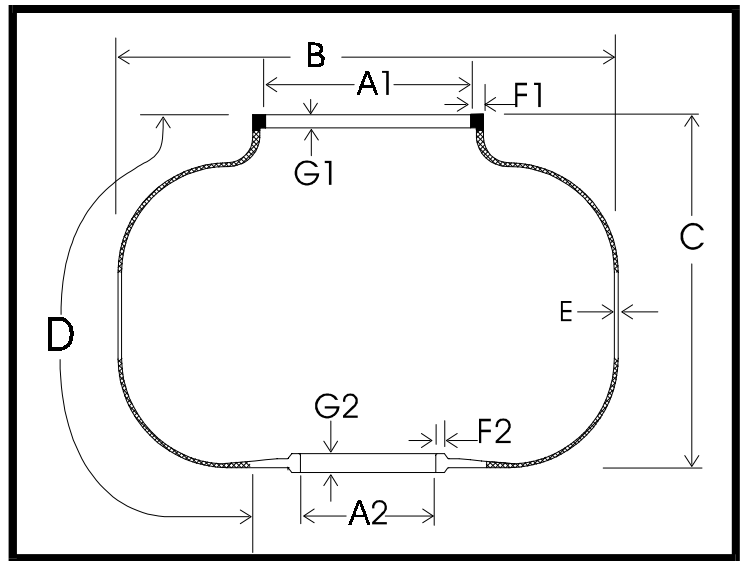

SPECIFICATIONS													
BLADDER CODE		Foot ID A1	Foot ID A2	Outside Diameter B	Overall Height C	Usable Periphery D	Crown Gauge E	Foot				Weight lb. kilo.	Bladder Vents / Etching
								Width F1	Width F2	Height G1	Height G2		
901	inch	9.11	6.00	21.50	12.93	20.80	0.17	0.50	0.50	0.59	0.85	8.65	V / E
	mm	231.4	152.4	546.1	328.4	528.3	4.2	12.7	12.7	15.0	21.6	3.92	
902	inch	9.11	6.00	22.20	17.00	25.50	0.17	0.50	0.50	0.68	0.85	10.32	V / E
	mm	231.4	152.4	563.9	431.8	647.7	4.3	12.7	12.7	17.3	21.6	4.68	
903	inch	9.11	6.00	22.20	17.00	25.50	0.20	0.50	0.50	0.68	0.85	12.58	V / E
	mm	231.4	152.4	563.9	431.8	647.7	5.1	12.7	12.7	17.3	21.6	5.71	
904	inch	10.50	7.50	25.25	17.70	25.28	0.24	0.57	0.56	0.54	0.82	16.25	V / E
	mm	266.7	190.5	641.4	449.6	642.1	6.1	14.5	14.2	13.7	20.9	7.37	
911	inch	8.92	6.12	20.87	12.48	21.35	0.17	0.70	0.50	0.74	0.82	9.21	V / E *
	mm	226.6	155.4	530.1	317.0	542.3	4.3	17.8	12.7	18.8	20.8	4.18	

\* 911 rib vent depth: 0.024in. (0.61mm.)